

CLASSIC AND EXCLUSIVE SERIES - Specification Guide

Installation Type :: Wall Mount (Classic) and Floor-to-ceiling (Exclusive) | Display Options :: S1, S2, S3, M1, M2, M3, DM1, DM2 & LS | Colour Options :: 13 Colours available | Capacity :: Based on configuration | Pricing :: Based on configuration

Classic Series (Wall-mount) and Exclusive Series (Floor-to-ceiling) are available in custom configured heights from min. 48" (1219.2mm) to max. 120" (3048mm).

Modular components consist of standard (S), magnum (M) and double magnum (DM) sized bottle holders (1, 2 and 3 deep) as well as LED lightshelves (LS). A combination of any of standard components and colours can make up single or multiple systems.

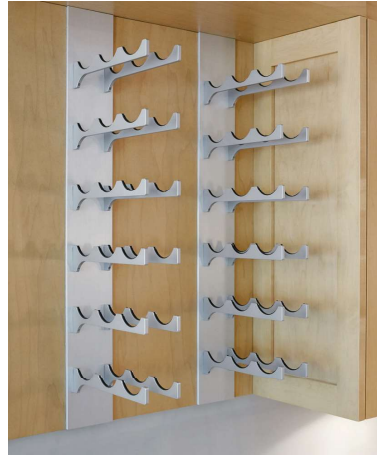

Classic Series

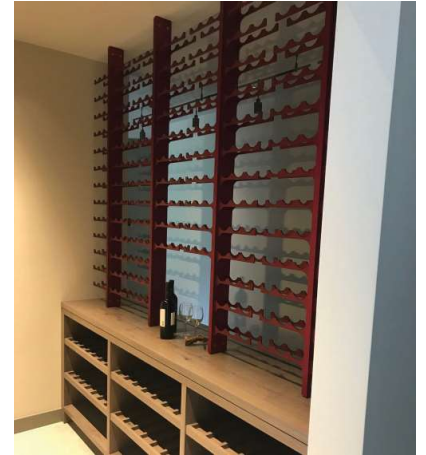

Exclusive Series

DISPLAY OPTIONS

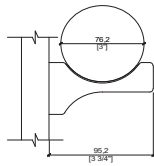
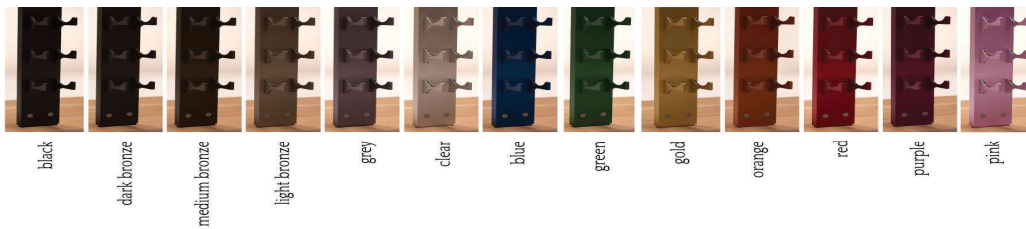

Standard - 1 Bottle (S1)

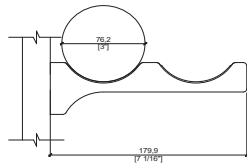

Standard - 2 Bottle (S2)

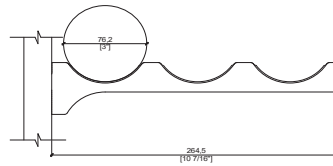

Standard - 3 Bottle (S3)

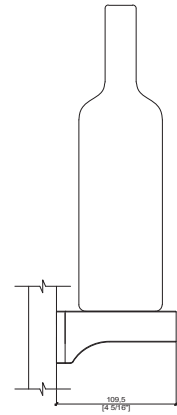

Light Shelf (LS)

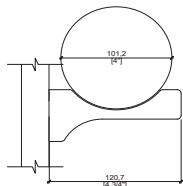

Magnum- 1 Bottle (M1)

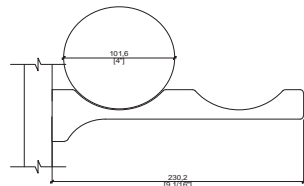

Magnum- 2 Bottle (M2)

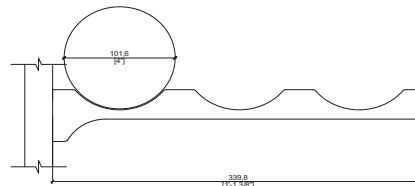

Magnum- 3 Bottle (M3)

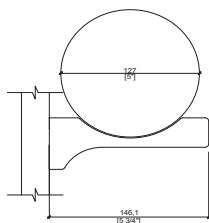

Double Magnum- 1 Bottle (DM1)

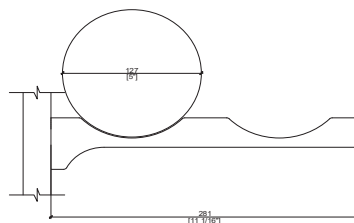

Double Magnum- 2 Bottle (DM2)

CLASSIC SERIES - Specification Guide

CLASSIC SERIES CONFIGURATION OPTIONS

STANDARD BOTTLE SPACING (S1, S2, S3)

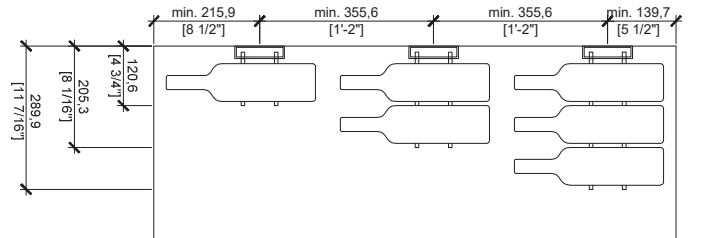

MAGNUM BOTTLE SPACING (M1, M2, M3)

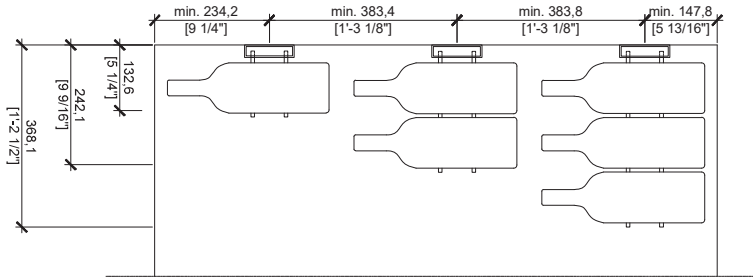

DOUBLE MAGNUM BOTTLE SPACING (DM1 & DM2)

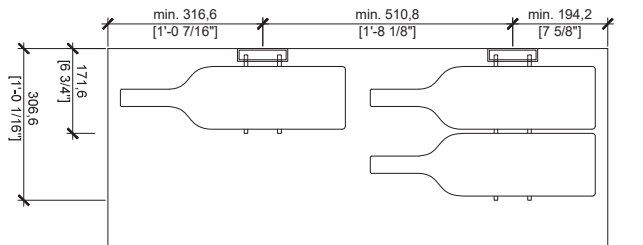

LIGHTSHELF DISPLAY

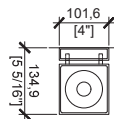

CLASSIC SERIES - Specification Guide

CLASSIC SERIES POST AND FIN DETAILS

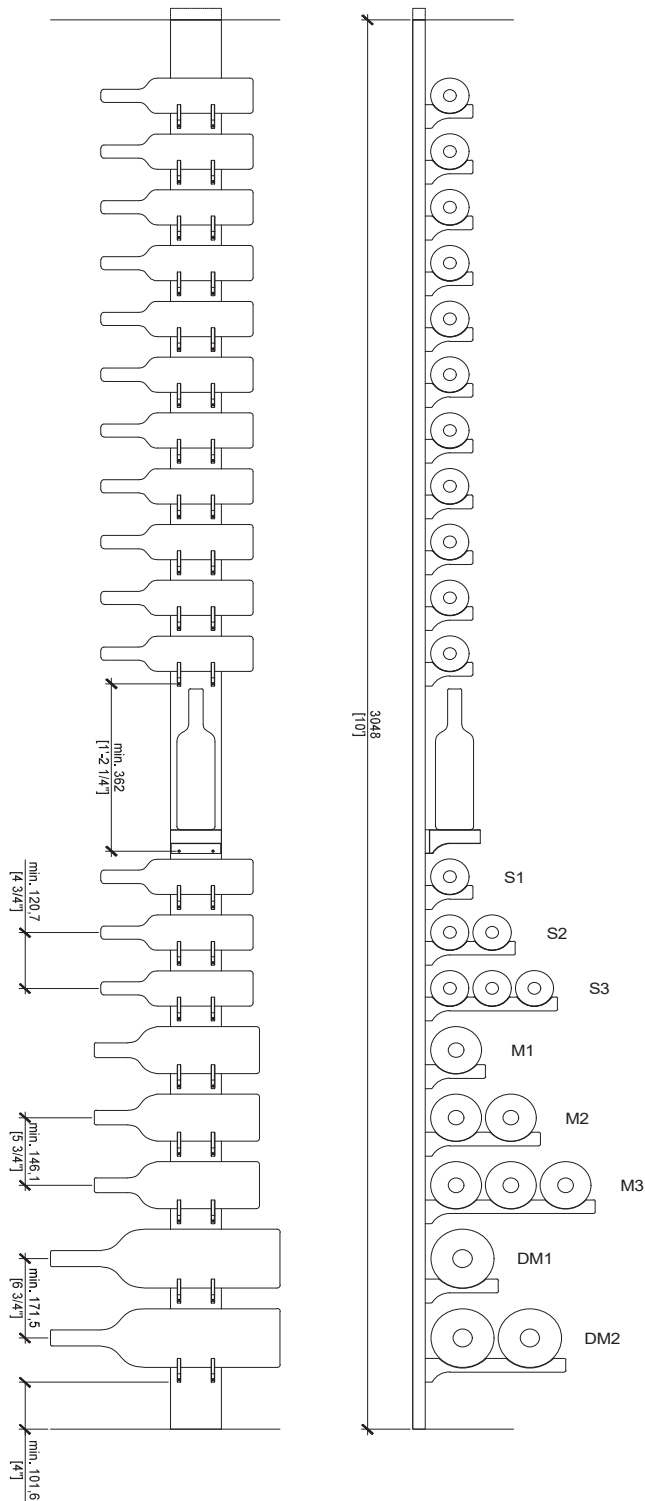

CLASSIC and EXCLUSIVE SERIES - Row Calculation

Height of System	Number of Rows
120" (3048mm)	24
114" (2895.6mm)	22
108" (2743.2mm)	21
102" (2590.8mm)	20
96" (2438.4mm)	19
90" (2286mm)	17
84" (2133.6mm)	16
78" (1981.2mm)	15
72" (1828.8mm)	14
66" (1676.4mm)	12
60" (1524mm)	11
54" (1371.6mm)	10
48" (1219.2mm)	9
42" (1066.8mm)	7
36" (914.4mm)	6
30" (762mm)	5
24" (609.6mm)	4
18" (457.2mm)	2
12" (304.8mm)	1